



78 Lutterworth Drive, Adwick-Le-Street

, Doncaster, DN6 7DW

Offers over £200,000



This beautifully presented three-bedroom semi-detached home has been thoughtfully extended and modernised throughout to create a truly impressive family residence. Offering spacious and versatile accommodation, the property combines contemporary design with practical family living and must be viewed internally to be fully appreciated.

The heart of the home is undoubtedly the spectacular open-plan kitchen, dining and entertaining space. Featuring a stylish high-gloss fitted kitchen with a substantial central island, integrated appliances, breakfast bar seating and striking pendant lighting, this stunning room is flooded with natural light from the impressive roof lantern and provides the perfect setting for modern family life and entertaining guests.

The ground floor further benefits from a generous lounge offering a warm and inviting atmosphere, together with a beautifully appointed contemporary shower room and additional living space created by the side and rear extensions.

To the first floor are three well-proportioned bedrooms and a modern family bathroom finished to an excellent standard.



- Hallway 4'6" x 9'4" (1.38 x 2.85)
- Lounge 15'5" x 12'4" (4.71 x 3.78)
- Dining Room 9'6" x 12'0" (2.92 x 3.67)
- Utility 4'4" x 3'5" (1.34 x 1.06)
- Shower Room 5'4" x 5'11" (1.63 x 1.82)
- Kitchen 15'5" x 10'2" (4.71 x 3.11)
- Master Bedroom 10'11" x 9'3" (3.34 x 2.84)
- Bedroom 2 7'5" x 11'7" (2.27 x 3.54)
- Bedroom 3 7'10" x 8'5" (2.39 x 2.58)
- Bathroom 4'3" x 9'2" (1.32 x 2.81)
- Landing 13'8" x 2'1" (4.17 x 0.65)

Area Map



Floor Plans

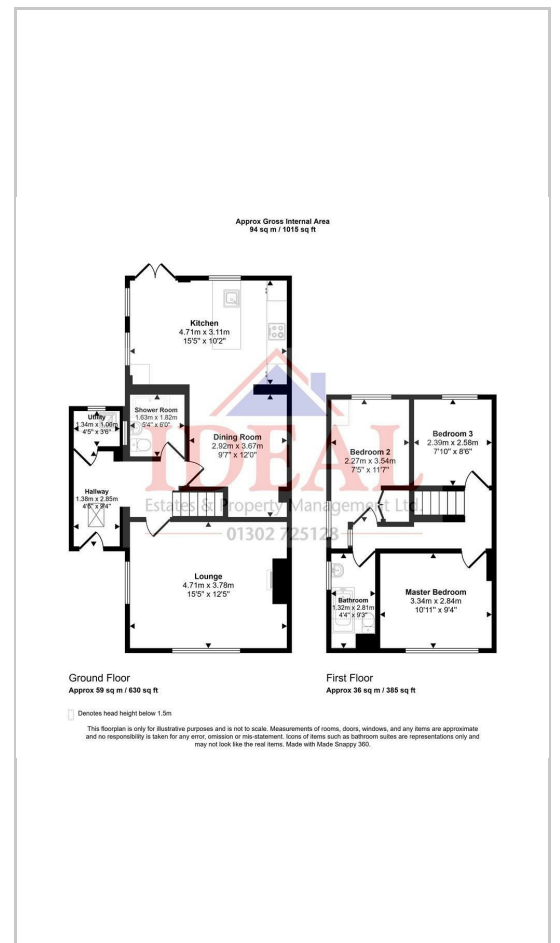

Energy Efficiency Graph

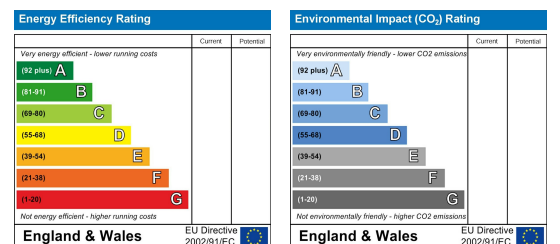

These particulars, whilst believed to be accurate are set out as a general outline only for guidance and do not constitute any part of an offer or contract. Intending purchasers should not rely on them as statements of representation of fact, but must satisfy themselves by inspection or otherwise as to their accuracy. No person in this firm's employment has the authority to make or give any representation or warranty in respect of the property.

